

T 1

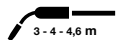

V peak	113	Ø mm	0.6 - 0.8 1.0 - 1.2	X 60%	180A CO ₂ 125A Mix
------------------	-----	----------------	------------------------	-----------------	----------------------------------

CODE	↔	
F16901MK3	3 m / 10'	TWECO®
F16901MK4	4 m / 12'	TWECO®
F16901MK5	4,6 m / 15'	TWECO®
F16901E3	3 m / 10'	EURO - TW
F16901E4	4 m / 12'	EURO - TW
F16901E5	4,6 m / 15'	EURO - TW

PRATIX
EQUIPMENT

EN 60974-7



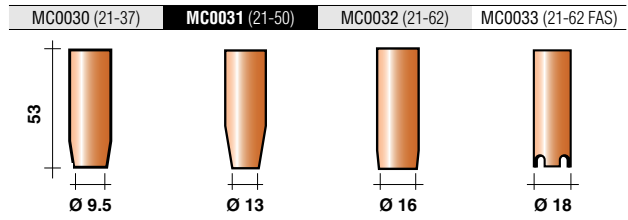
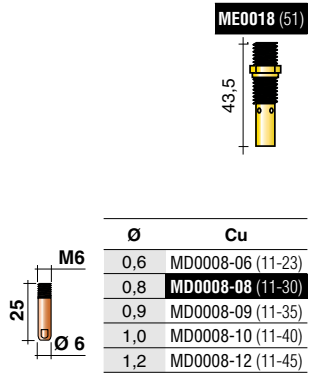

STANDARD (REF)

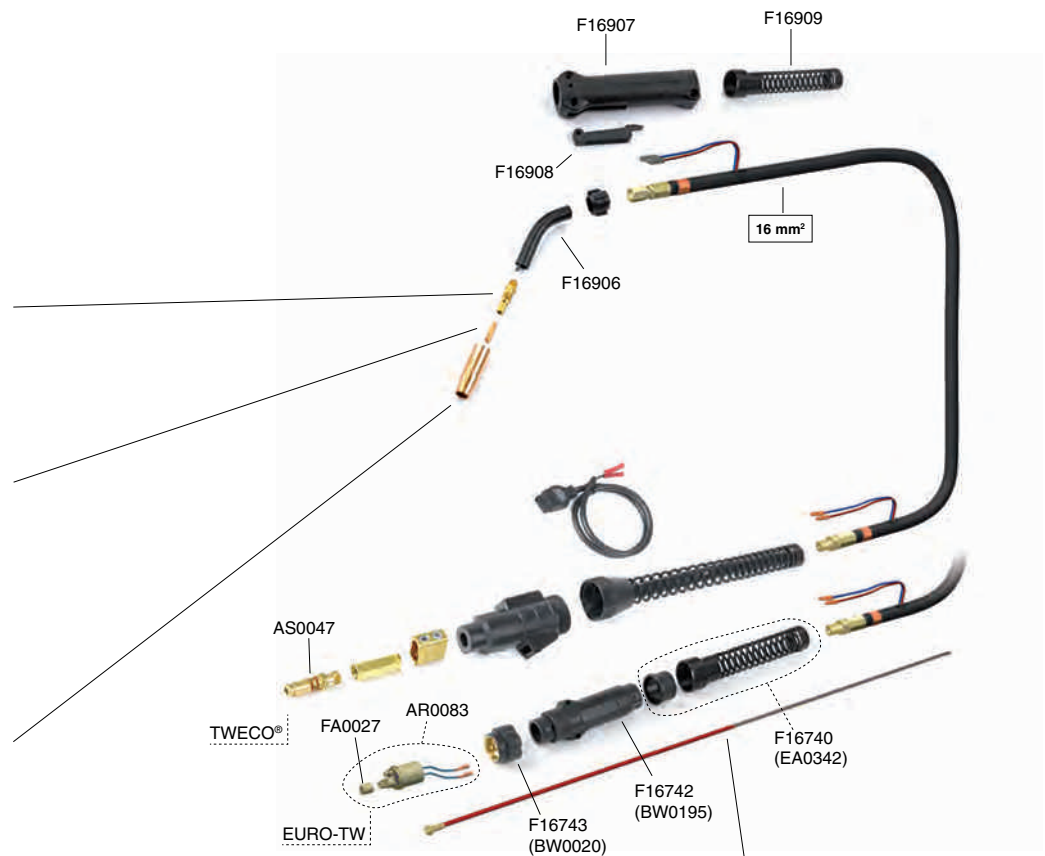

Wire 1,0 ÷ 1,2	red color
	m Steel
	4,6 GM0012 (42-4045-15)